

Guildford Town Centre Transport Package G-Bug Update

25 November 2019

Walnut Tree Close experimental one-way closure

- Lease agreement with GBC has been finalised for the construction of a vehicle turning area to enable the experimental one-way closure on Walnut Tree Close
- Coordination issues with the construction of the Walnut Bridge which is being delivered by GBC
- Construction of the turning area will start on week of 6 January 2020 for a period of 8 weeks
- Trial will start after the construction of Walnut Bridge
- One week before the trial, the cycling design elements will be installed. These will be temporary in nature.

The conversion of Walnut Tree Close from one-way to two-way operation would require the following works:

- Cycle lane segregation to be removed (including fixing works for the reinstatement of the carriageway)
- Road markings identifying the one-way system to be removed.
- Appropriate signage to be installed.

Preferred Option



Model	Wand Orca End Section	Wand Orca Middle Section
Colour	Black/White (Red, Grey or Granite Grey)	Black/White (Red, Grey or Granite Grey)
Fixings	3 x per end	4 x per middle
Width	175mm	175mm
Length	750mm	1000mm
Height	80mm	80mm
Weight	7.9kg	10.5kg



Greenwich Wand Orca

- Greenwich Wand Orca separators are proposed to separate the mandatory cycle lane on the south side of the carriageway with minimum spacing of 10m between each other and at a minimum length of 2.5m long
- Ideal for segregation over longer distances where vehicle speeds may be higher.

Typical Cross Section for One Way System

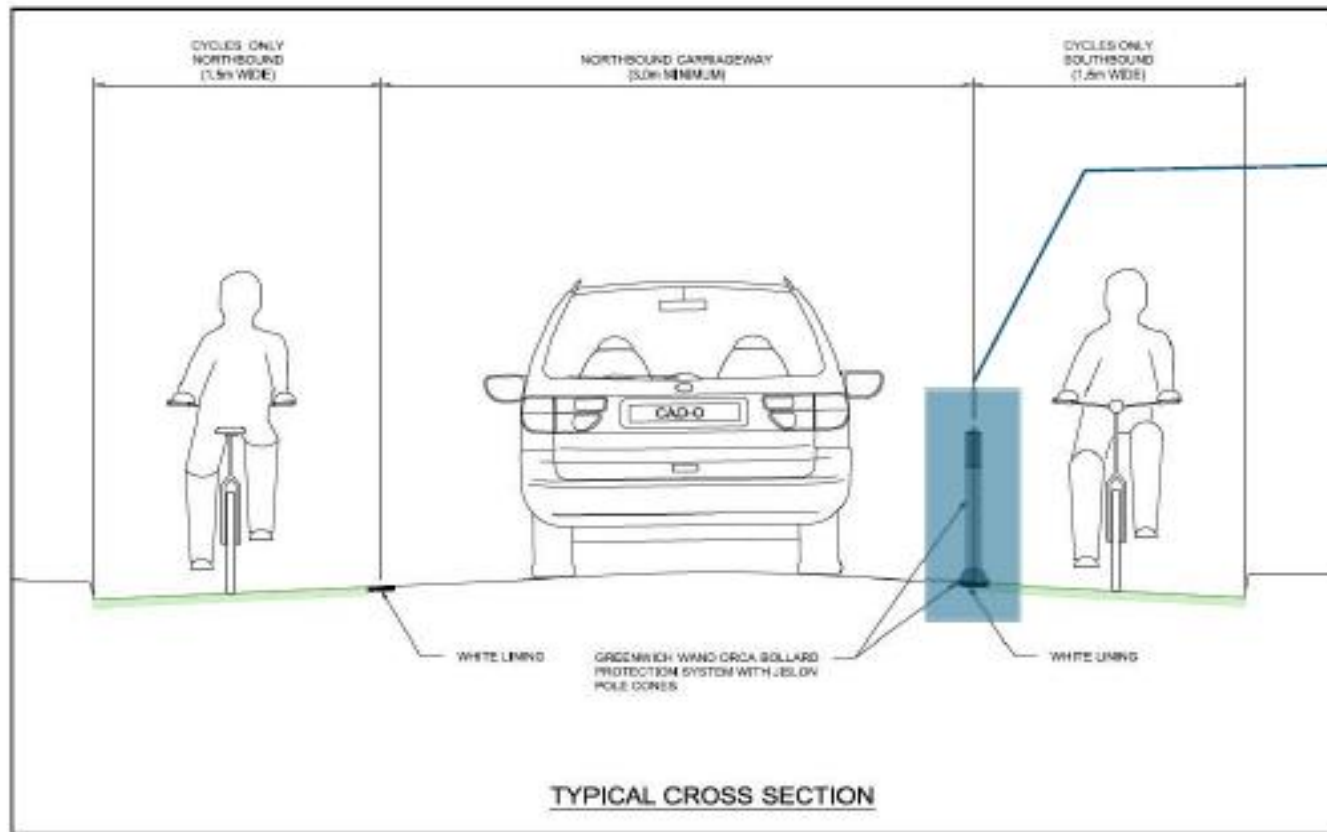

Location for installing removable separation. (currently showing Greenwich Wand Orca system as proposed by the scheme)

A3100 London Road

Outline design work has now been completed on the A3100 London Road and a final route alignment has been agreed.

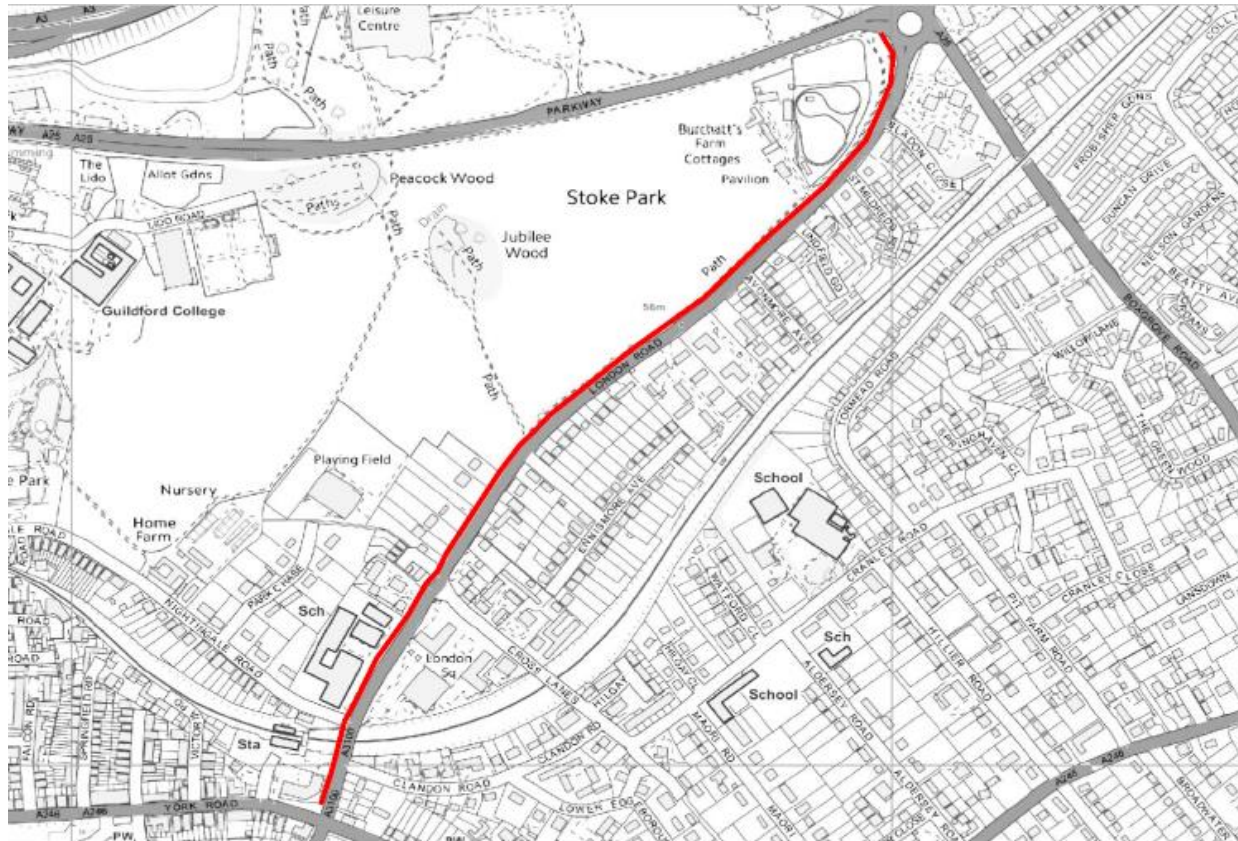

	<small>CG terms & conditions: You are granted a non-exclusive, royalty free, revocable licence solely to view the Licensed Data for non-commercial purposes for the period during which Surrey County Council makes it available. You are not permitted to copy, sub-licence, distribute, sell or otherwise make available the Licensed Data to third parties in any form. Third party rights to enforce the terms of this licence shall be reserved to CG.</small>	Printed By: Jeff Wilson
		Printed On: 04/11/2019
		Project No: Guildford TCTP
		Scale: 1:25000

A3100 London Road cycle path



A3100 London Road cont'd

The scheme is also expected to include the installation of a new signalised 'toucan crossing' facility between Cross Lanes and Stoke Park and the existing pelican crossing on the railway overbridge near London Road rail station will also be upgraded to a toucan.

Plan for construction to start during summer 2020, rather than during the spring, to coincide with the school holiday period and avoid conflict with the Surrey County Show at Stoke Park during May.

Targeted engagement is planned to take place with local stakeholders and members over the next quarter to provide further information during the run up to works commencing as the finer details are agreed during detailed design.

Guildford College Link

Preferred location for a critical signalised crossing over A322 Woodbridge Road

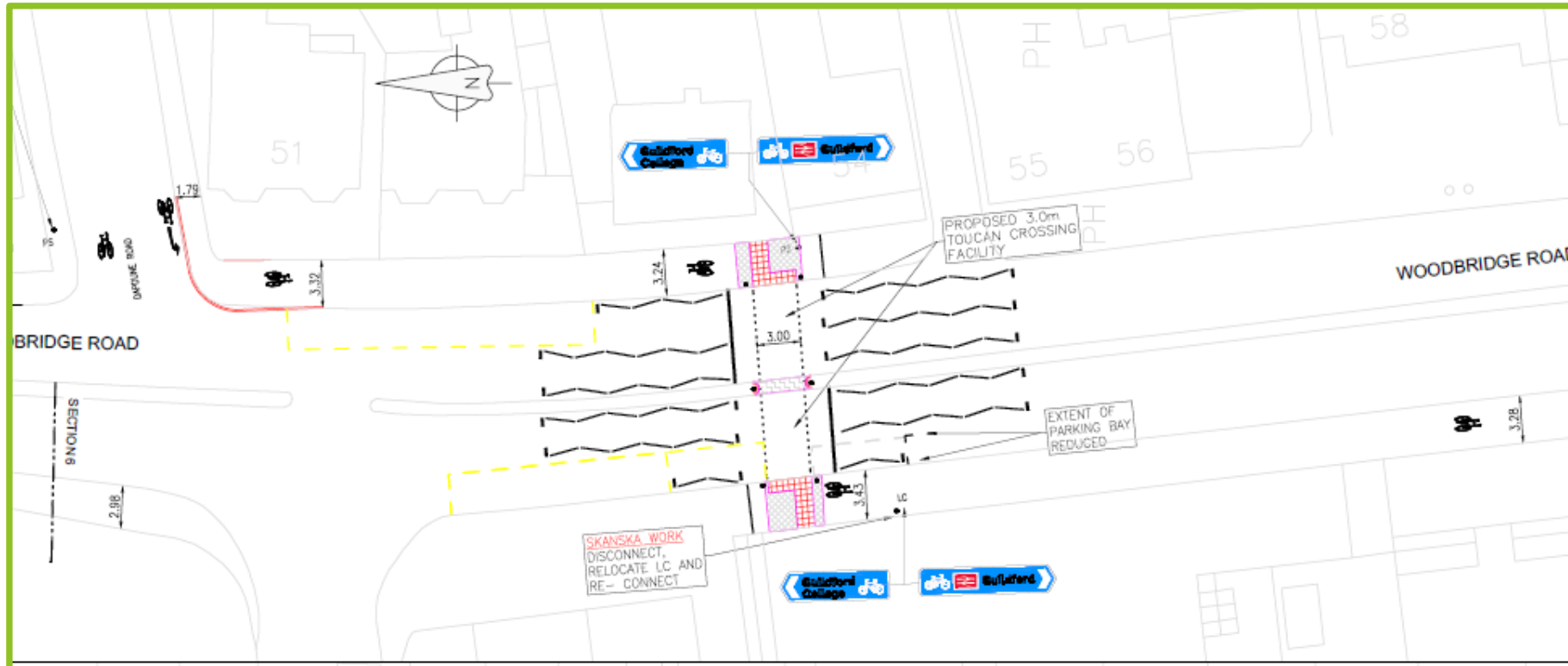

Guildford College Link cont'd

- Preferred location for a new crossing will require relocation of the north and southbound bus stops and some parking bays
- Camera surveys have been commissioned to understand the parking situation and to develop a solution that would be agreeable to the residents in the area

Guildford College Link - Crossings

