

DO NOT SCALE
0 10 100
Millimetres

FOR CONTINUATION REFER TO SHEET 1

FOR CONTINUATION REFER TO SHEET 3

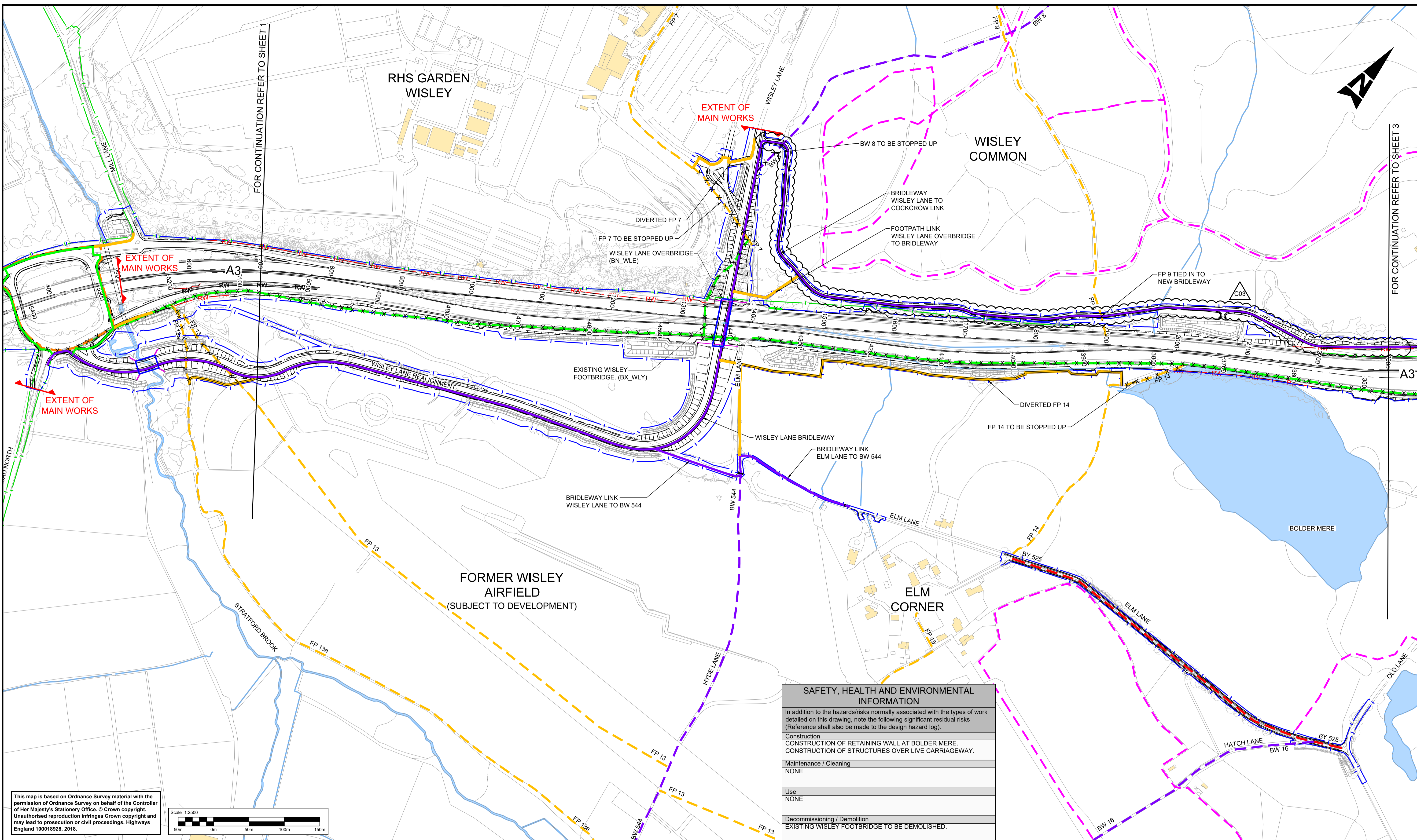

This map is based on Ordnance Survey material with the permission of Ordnance Survey on behalf of the Controller of Her Majesty's Stationary Office. © Crown copyright. Unauthorised reproduction infringes Crown copyright and may lead to prosecution or civil proceedings. Highways England 100018926, 2018.

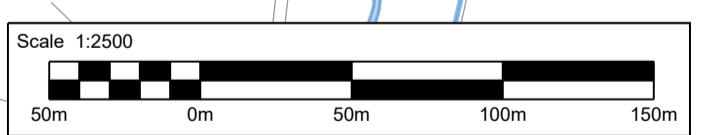

SAFETY, HEALTH AND ENVIRONMENTAL INFORMATION	
In addition to the hazards/risks normally associated with the types of work detailed on this drawing, note the following significant residual risks (Reference shall also be made to the design hazard log).	
Construction	CONSTRUCTION OF RETAINING WALL AT BOLDER MERE. CONSTRUCTION OF STRUCTURES OVER LIVE CARRIAGEWAY.
Maintenance / Cleaning	NONE
Use	NONE
Decommissioning / Demolition	EXISTING WISLEY FOOTBRIDGE TO BE DEMOLISHED.

LEGEND:			
	EXISTING FOOTPATH		PROPOSED FOOTPATH
	EXISTING CYCLE TRACK		PROPOSED CYCLE TRACK
	EXISTING BRIDLEWAY		PROPOSED BRIDLEWAY
	EXISTING SHARED USE ROUTE		PROPOSED FOOTWAY/CYCLE TRACK
	EXISTING BYWAY		EXISTING ROUTE TO BE DECOMMISSIONED. NOT NECESSARILY LENGTH TO BE LEGALLY STOPPED UP
	EXISTING SIGNPOSTED EQUESTRIAN ROUTE		PROPOSED HIGHWAY BOUNDARY
	EXISTING HIGHWAY BOUNDARY		PROPOSED PRE-EARTHWORK DITCH (INDICATIVE ONLY)
	EXISTING WATERCOURSES/WATERBODIES		PROPOSED RETAINING WALL
	EXISTING BUILDINGS		PROPOSED WING WALL / REINFORCED EARTH WALL
	EXISTING OVERBRIDGE STRUCTURES		PROPOSED OVERBRIDGE STRUCTURES
	EXISTING UNDERBRIDGE STRUCTURES		PROPOSED UNDERBRIDGE STRUCTURES
	EXISTING RETAINING WALLS		PROPOSED ABUTMENT WALL / PIERS
	EXISTING BRIDLEWAY		PROPOSED POND (INDICATIVE ONLY)

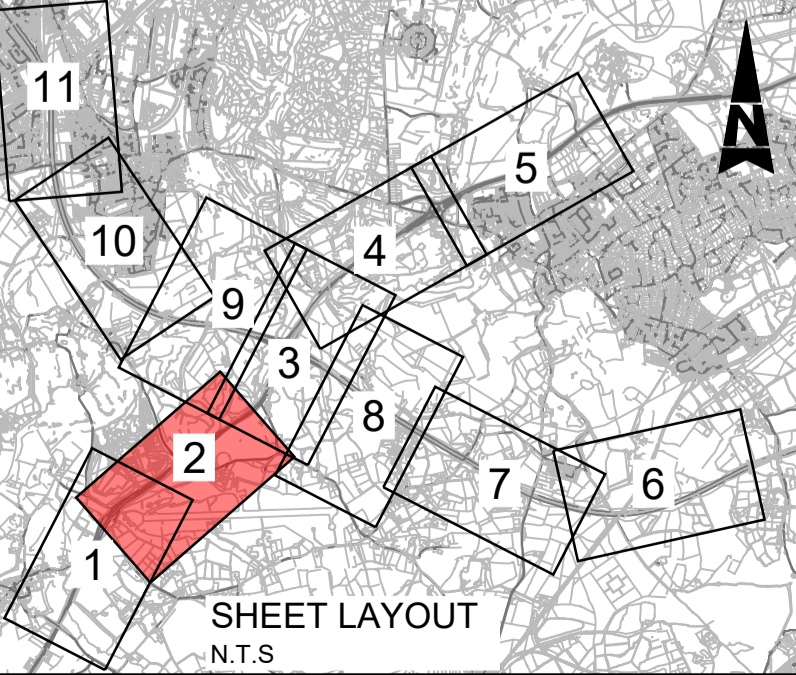

Description	Status	Revision	Drawn	Checked	Reviewed	Authorised	Issue Date
STAGE 3 DESIGN FIX 2	S3	P01	AM	AA	RM	---	05/01/18
STAGE 3 DESIGN FIX 2	A1	CO1	HA	AA	RM	PJ	09/01/18
STAGE 3 DESIGN FIX 3 - FOR HE REVIEW	B1	CO2	SA	LH	RM	VA	18/10/18
STAGE 3 DESIGN FIX 3.1 - FINAL SIGN OFF	A1	CO3	SA	VM	LH	VA	21/05/19

Drawing Suitability: APPROVED - PUBLISHED
Status: A1
Project Title: M25 Junction 10/A3 Wisley Interchange

SNC-LAVALIN | **ATKINS**
Epsom Gateway
Ashley Avenue
Epsom
Surrey
KT18 5AL
Tel: +44 (0)1372 726140
Fax: +44 (0)1372 740055
www.atkinsglobal.com

Copyright © Atkins Limited (2018)

Client: Working on behalf of **highways england**

Drawing Title	Drawing Number	Originator	Volume
EXISTING AND PROPOSED NON-MOTORISED USER ROUTES	HE551522	ATK	ENM
	A3_ML	DR	CH - 000002
		Type	Role
Original Size: A1	Scale: 1:2500	Project Ref. No.: 5158141	Sheet: 2 of 11
			Rev: C03